

LEGEND

- SID APPLICATION SITE BOUNDARY
- LANDS IN OWNERSHIP OF SOUTH DUBLIN COUNTY COUNCIL
- LANDS IN OWNERSHIP OF GOOGLE IRELAND Ltd.
- LANDS IN OWNERSHIP OF ESB NETWORKS
- LANDS IN OWNERSHIP OF MOFFASH Ltd.
- LANDS IN OWNERSHIP OF VANTAGE DATA CENTERS

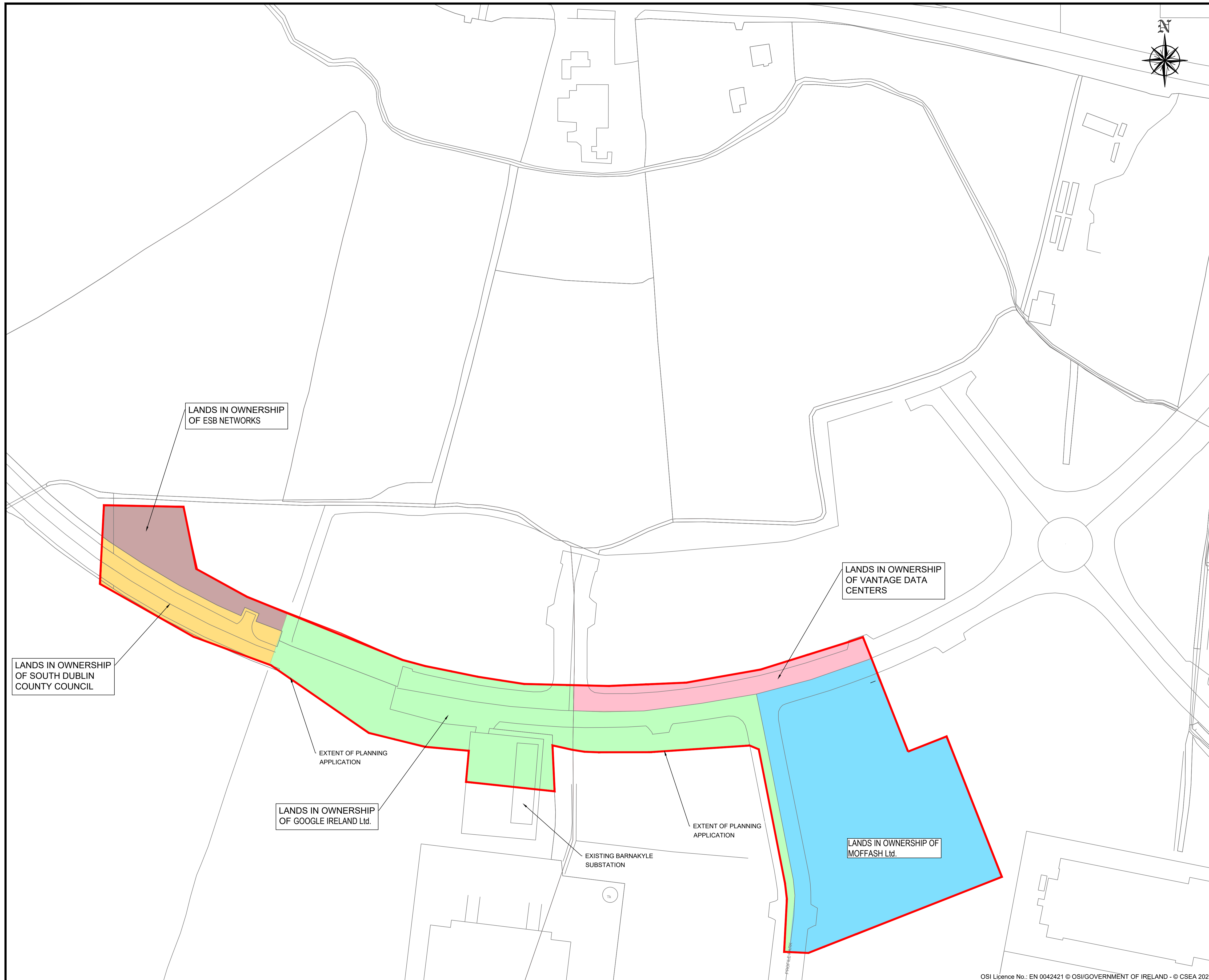

NOTE

LANDOWNERSHIP BOUNDARIES SHOWN ARE INDICATIVE AND TO BE USED FOR LETTER OF CONSENTS ASSOCIATED WITH THE SUB-STATION SID PLANNING APPLICATION ONLY.

Rev	Description	Drawn	Checked	Date
P02	FOR INFORMATION	DM	PM	14.02.2022
P01	FOR INFORMATION	DM	PM	15.12.2021

Clifton Scannell Emerson Associates Limited
 Consulting Engineers,
 3rd Floor, The Highline,
 Bakers Point, Pottery Road,
 Dun Laoghaire, Co. Dublin,
 Ireland, A96 KW29

T: +353 1 288 5006
 F: +353 1 283 3466
 E: info@csea.ie
 W: www.csea.ie

VANTAGE DATA CENTERS

Client: **KILCARBERY 110KV SUBSTATION & MV CLIENT COMPOUND**

Project: **LAND OWNERSHIP MAP**

Dwg. Title: ----

Drawn By: **DM** Date: **OCT 2021** **21_115**

Checked By: **PM** Scale: **1:1000 @ A1** CSEA Job No.:

Project Code	Originator	Zone/Phase	Level	Type	Role	Dwg. No.
21_115	CSE	00	XX	DR	C	1006

Status Code: **S2** FOR INFORMATION

Revision: **P02** Project Status: **PLANNING**